

Installation Guide for 75mm, 100mm & 150mm Edging

1 Step 1: Site Preparation

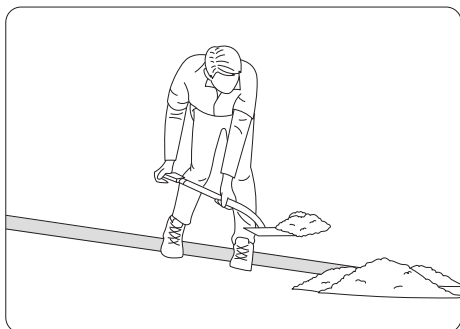

Begin by marking out the desired line for your edging using a suitable survey marking product.

Use a spade and or mattock to cut away any lawn or clear any vegetation along this line.

Using a trenching shovel excavate a trench wide and deep enough to accommodate the edging, ensuring it will finish level with your desired height once installed. Remove any lawn, rocks or roots that will impede the installation of the edging.

Tip

It's better to dig the trench slightly deeper than required. Adjustments to the finished level of the edging can be made during installation.

2 Step 2: Lay the edging

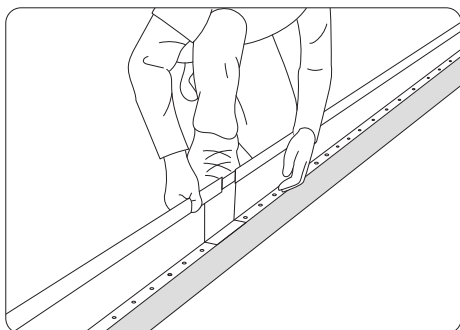

Place 2-3 lengths of your garden edging into the trench at a time.

Adjust the edging as needed to create smooth curves or straight edges, depending on your design.

Take your time to align the edging properly for a clean finish.

3 Step 3: Joining

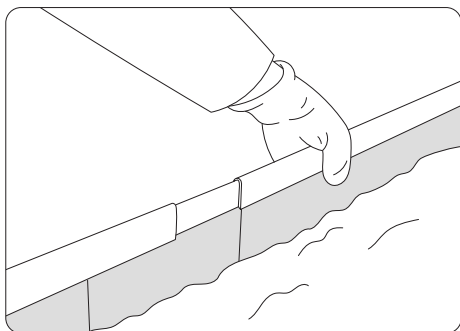

Where two pieces of edging meet, use joiners to connect the section securely.

Each edging length is supplied with a joiner piece pre-attached.

This will slide easily into the end of the following length and can be secured using two Tek screws in the pre-drilled holes on the foot.

This step is crucial for maintaining continuity and preventing unsightly gaps.

4 Step 4: Leveling

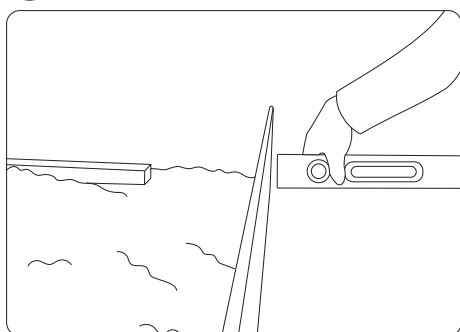

For straight sections use a builder's line set at the finished height of the edging.

Check the top of the edging to ensure it is level and consistent along the entire length.

Use a spirit level for curved sections.

Make any final adjustments as needed for a polished, professional finish.

5 Step 5: Bracing

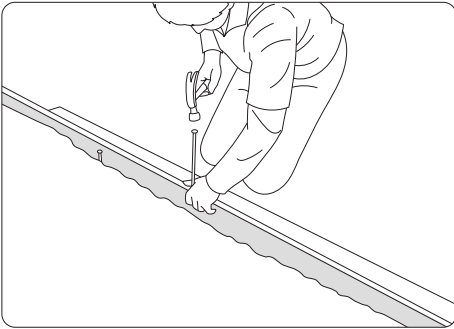

In conjunction with leveling the edging in the previous step, insert the supplied braces along the edging length.

Position them at regular intervals to maintain the edging's alignment and stability.

The top of the brace fits under the folded top edge of the edging and the hole in the foot of the brace aligns with the holes in the foot of the edging.

Secure each brace using the supplied twisted nails, the nails are inserted through the brace tongue, brace foot and edging foot, ensuring they anchor the edging to the ground effectively.

6 Step 6: Backfilling



Once the edging is secure, use a rake or shovel to backfill the trench with the soil or material you initially removed.

Pack the soil firmly around the base of the edging to provide additional stability.

7 Step 7: Corners

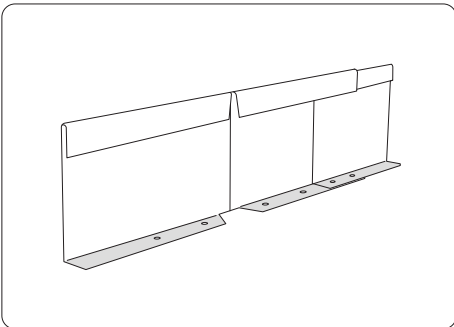

Prefabricated corner pieces are available for all sizes. They are supplied flat so they can be bent to any angle onsite by hand.

If the need to manufacture a corner onsite is required. Use an angle grinder to cut a V in the foot and the top edge then score the fold line to make it easier to fold by hand. Please follow all safety guidelines and wear suitable PPE.

Useful Tools for installing Garden Edging

Spade
Mattock
Trenching shovel

Rake
Spirit Level
Builders Line

Drill
Rubber Mallet
Angle Grinder